

SILVER DAWN

'E' SERIES ONWARDS

SECTION H

PROPPELLER SHAFT AND UNIVERSAL JOINTS

CONTAINING:

GROUP 1.	PROPPELLER SHAFT FRONT
" 2.	PROPPELLER SHAFT REAR
" 3.	SUPPORT, CENTRE BEARING.

SCHEDULE OF SPARE PARTS

REF. NO. PART NO. QUANTITY GROUP ASS'LY NOTES

GROUP H.1. PROPELLER SHAFT FRONT

Comprising:-

BEARING, assembly, consisting of:-

	1	RG.3473	1	
Baffle		GB.5306	1	
Bearing, ball (Hoffman)		RG.4454	1	A
Bearing, ball (R. & M.)		RG.6589	1	A
Bearing, ball (Fischer)		RG.7084	1	A
Housing		GB.5305	1	
BOLT, .437" dia. flanges	X.2A	KB.8858/Z	8	
FLANGE, coupling, front to rear	2	GB.4386	1	
KEY, Woodruff, coupling flange .1875" wide	X.18	KC.515/Z	2	B
KEY, Woodruff, coupling flange .1680" wide		KC.516/Z	-	
KEY, Woodruff, coupling flange .1885" wide		KC.517/Z	-	
KEY, Woodruff, coupling flange .1890" wide		KC.518/Z	-	
NUT, centre bearing	3	GB.3159	1	
NUT, coupling flange retaining	X.24	K.4340/Z	1	
NUT, half, .437" dia. flange	X.24	K.4310/Z	8	
RETAINER, grease, front	4	GB.5308	1	
RETAINER, grease, rear	5	GB.5307	1	
SHAFT, propeller assembly, including	6	RG.3113	1	
Journal assembly		RG.6389	1	
Ring, snap (included in journal assy.)		K.3/7/GN.19	4	
WASHER, Grover, .437" dia. flanges	X.81	K.4511/Z	8	
WASHER, locking, centre bearing nut	7	RG.3189	1	
WASHER, locking coupling flange retaining nut	X.89	KB.2964	1	

GROUP H.2. PROPELLER SHAFT, REAR.

Comprising:-

BOLT, .437" dia. rear flange	X.2A	KB.8858/Z	4	
NUT, half, .437" dia. rear flange	X.24	K.4319/Z	4	
SHAFT, propeller, assembly, including:-	1	RG.6992	1	
Journal, assembly		RG.6389	2	
Ring, snap (included in journal assy.)		K.3/7/GB.19	8	
Nipple, Hardy Spicer		RG.6940	1	
WASHER, Grover, .437" dia. rear flange		K.4511/Z	4	

## SCHEDULE OF SPARE PARTS

REF. NO. PART NO.

QUANTITY  
GROUP ASS'LY

NOTES

## GROUP H.3. SUPPORT CENTRE BEARING.

Comprising:-

BOLT, 2 BA, bearing strap retaining	X.9	K.128/Z	1	
BOLT, .250" bracket to frame retaining	X.10	K.206/Z	3	
BOLT, .500" dia. bearing mounting retaining	1.A	RG.5991	2	
BRACKET, bearing, support, assembly, consisting of:-	1	RG.3472	1	
Bearing, Silentbloc		RG.3076		1
Bracket		RG.3462		1
Plate, locating		RG.3463		1
Rivet		KB.1977		2
CRADLE, bearing, assembly, consisting of:-	2	RG.3471	1	
Bearing, Silentbloc		RG.3076		1
Cradle		RG.3469		1
DISC, friction, Ferodo	3	RG.3466	4	
LINK, connecting, L.H.	4	RG.3468	1	
LINK, connecting, R.H.		RG.3467	1	
NUT, half, 2 BA. bearing strap, retaining bolt	X.24	K.4307/Z	1	
NUT, half, .250" dia. bracket to frame retaining bolt	X.24	K.4310/Z	3	
NUT, castellated .500" dia. bearing mounting retaining bolt	X.20	KB.3593/Z	2	
PIN, split, bearing, mounting bolt	X.31	K.4614/Z	2	
SPRING, bearing, mounting	6	RG.3464	1	
STRAP, shaft bearing	7	RG.3470	1	
WASHER, compression rubber	8	RG.3465	4	
WASHER, plain .250" dia. bracket to frame bolt	X.84	KB.3905/Z	3	
WASHER, plain .500" dia. bearing mounting	X.85	K.4419/Z	2	
WASHER, spring 2 BA. bearing strap retaining bolt	X.87	K.9006/Z	1	
WASHER, spring, .250" dia. bracket to frame retaining bolt	X.87	K.9008/Z	3	

GROUP H 1

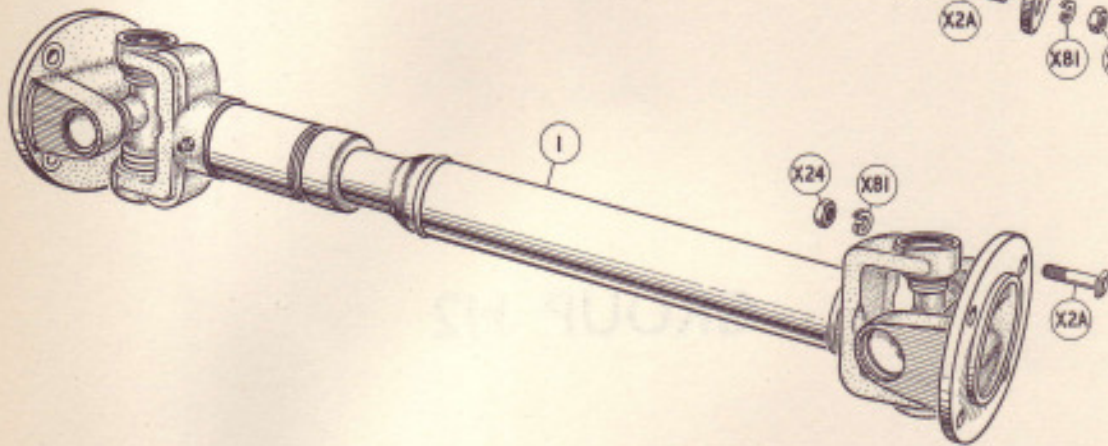
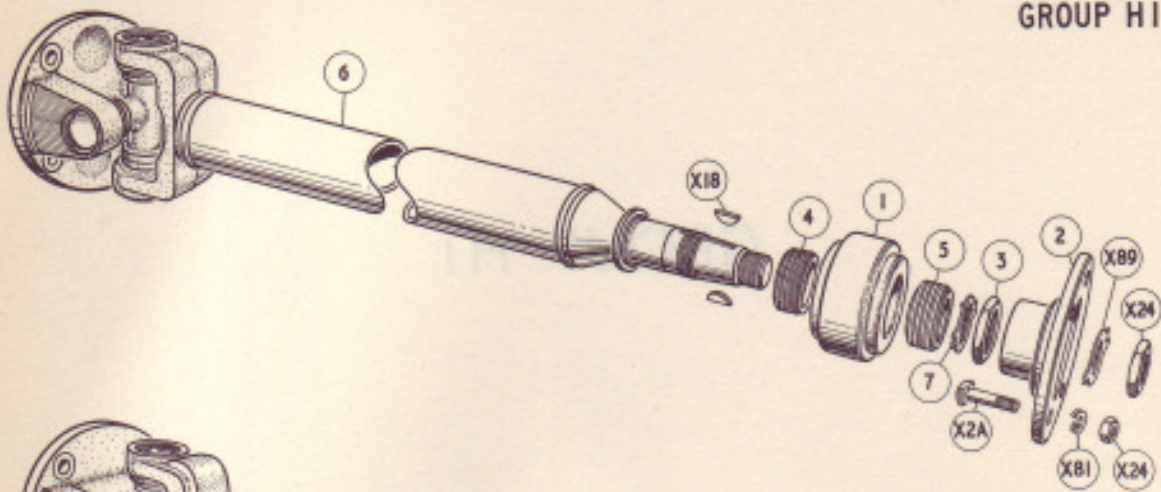

GROUP H 2

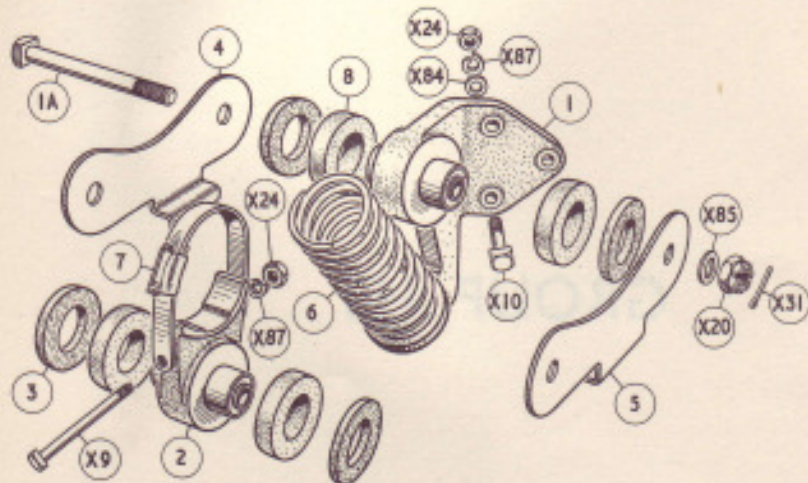

GROUP H 3