

## SECTION 8 . . PRESSURE CONTROL VALVE

During overhaul, the procedure for removing, cleaning and refitting of the pressure control valve is similar to that described in Chapter 2 with the addition of the following points.

Examine the inner and outer rubber cushions for condition, and if they show any signs of deterioration or damage, remove and fit new ones, after first dipping into clean gearbox oil.

Remove the oil seal ring and joint washer from the blanking plug and examine the threads for signs of

'picking-up' and embedded dirt; similarly inspect the threads in the gearbox, then screw the plug into the gearbox to check for freeness.

Fit a new seal ring and joint washer, then assemble the unit as described in Chapter 2 and refit to the gearbox. Finally tighten to the correct torque loading given in the summary.

To check the operation of the pressure control valve, carry out the oil pressure test described in Chapter 2.

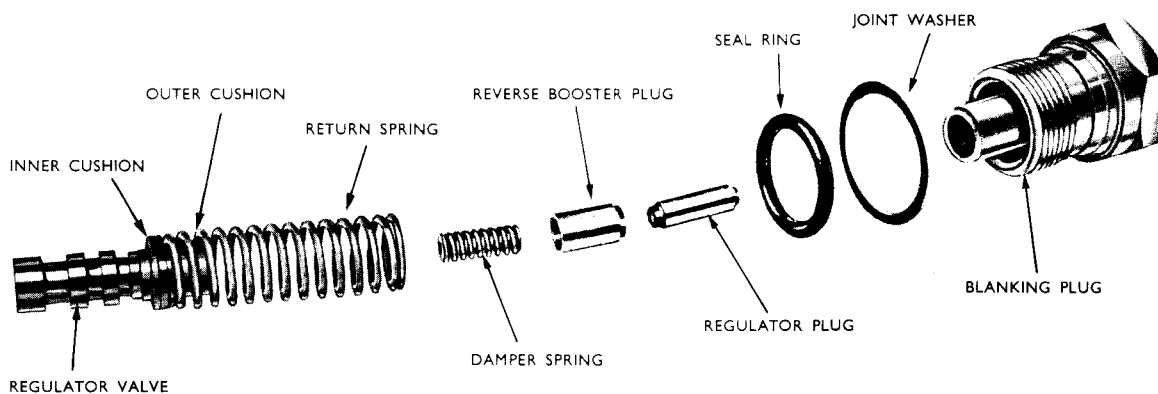

Fig. 1 Exploded view of pressure control valve